



University of  
**Nottingham**

UK | CHINA | MALAYSIA

# COVID in UK Care Homes

Adam Gordon,  
Professor of the Care of Older People  
University of Nottingham, UK



@adamgordon1978

# My perspective

- A decade working with and researching in the care home sector.
- Online COVID community of practice
  - 250 members on WhatsApp
  - >1000 members on the wider platform
- BGS spokesperson on care homes, and lead author on BGS guidance on care homes

ACCEPTED MANUSCRIPT

# Commentary: COVID in Care Homes—Challenges and Dilemmas in Healthcare Delivery

Adam L Gordon , Claire Goodman, Wilco Achterberg, Robert O Barker, Eileen Burns, Barbara Hanratty, Finbarr C Martin, Julienne Meyer, Desmond O'Neill, Jos Schols ... [Show more](#)

*Age and Ageing*, afaa113, <https://doi.org/10.1093/ageing/afaa113>

**Published:** 13 May 2020    **Article history** ▼

# What the care home sector looked like when this started

- Circa 430,000 residents (450,000 registered beds) in UK care homes.
- About 1/3 are nursing homes.
- 3 times the size of the UK acute care sector.
- Almost all residents have multiple long term conditions.
- Providers largely not state-run – long-standing issue with the level of state reimbursement for care.
- Healthcare to care homes is variable – co-ordinated GP input and integrated planning for healthcare delivery on the “to do” list in many areas.
- No minimum dataset – ongoing research to establish how that should look.

# What has happened since?

- Advance care planning.
- Admissions and discharges.
- Isolation and Zoning.
- Access to tests.
- Recording deaths.
- PPE.
- Augmented medical support.
- Staff and sectoral recognition.

**BGS**

**British Geriatrics Society**  
Improving healthcare  
for older people

<https://www.bgs.org.uk/resources/covid-19-managing-the-covid-19-pandemic-in-care-homes>

# COVID-19: Managing the COVID-19 pandemic in care homes for older people

GOOD PRACTICE GUIDE 

Authors:

British Geriatrics Society

Date Published:

30 March 2020

Last updated:

14 April 2020

# Advanced care planning

- Why

- Many residents near the end-of-life
- Discussions about escalation are important
- Some would choose not to go to hospital

- Problems

- Trying to do it “remotely”
- Any attempts to do it in a “blanket” way, without considering individual circumstances.
- Putting too much on care home staff.
- Clumsy or inappropriate attempts make it difficult even for those of us that do it well

Donate to our NHS campaign - and you could win a prize for you or an NHS hero >

JOB S FOOTIES ADVERTISING VOUCHER CODES DIRECTORY FUNERAL NOTICES MARKETPLACE DATING BOOK AN AD PUBLIC NOTICES

M EN News > Greater Manchester News > Coronavirus

# Elderly people with coronavirus 'denied hospital beds and left to die in care homes'

Shadow social care minister Barbara Keeley says there have been five coronavirus deaths in one Salford residential home alone - and warns the care system is being treated as an 'afterthought' by government





# Coronavirus: GP surgery apology over 'do not resuscitate' form

🕒 1 April 2020

[f](#) [📧](#) [🐦](#) [✉](#) [Share](#)

Coronavirus pandemic



Elizabeth John said the letter was like a "death warrant from the Grim Reaper"

# COVID-19 Hospital Discharge Service Requirements

Published 19 March 2020

# Admission and Care of Residents during COVID-19 Incident in a Care Home

Version 1

Published 2 April 2020

This guidance is being reviewed following the publication of the adult social care action plan on 15 April 2020. We will publish updated guidance soon.

In the interim, please see the following paragraphs in the [adult social care action plan](#) for up-to-date guidance on:

- testing: paragraphs 1.30 and 1.32
- end of life care: paragraph 3.13

# Currently

- 14 day isolation for symptomatic residents or COVID +ve residents on admission
- Many homes are extending this to 14 day isolation for all residents on admission.
- Same process for those already resident in the home if they become symptomatic.
- BGS Guidelines suggest homes consider managing all residents in their rooms as much as possible....but supervision, staffing, social isolation, and deconditioning are issues.

## Delineation of risk zones - adapted for care homes

▲ Hand hygiene

Adapted from traffic control bundling concept in:  
Yen, M.Y. *et al* (2011) and (2020)

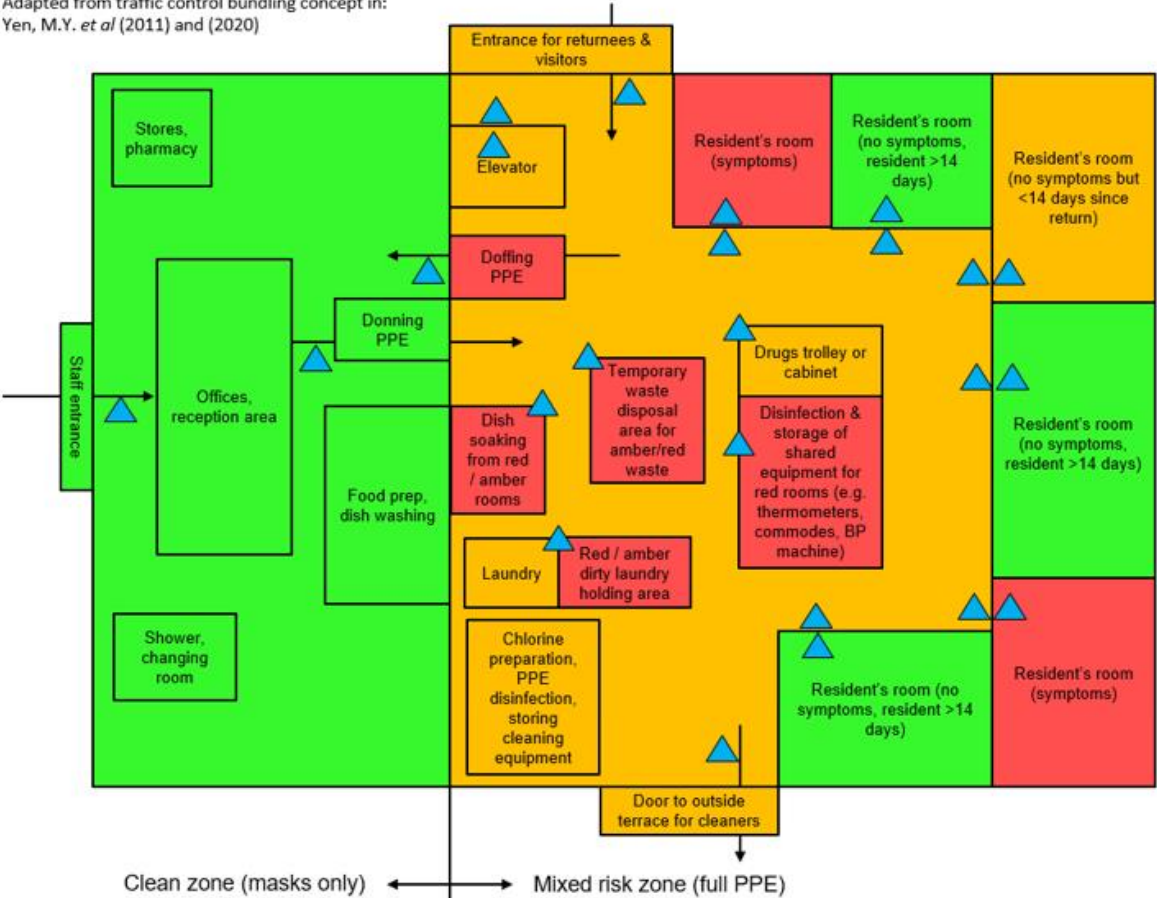

# Access to tests

- From isolate if asymptomatic

to

- First five residents will be tested

to

- Blanket testing of all UK residents and staff



■ Excess deaths

## Hospital

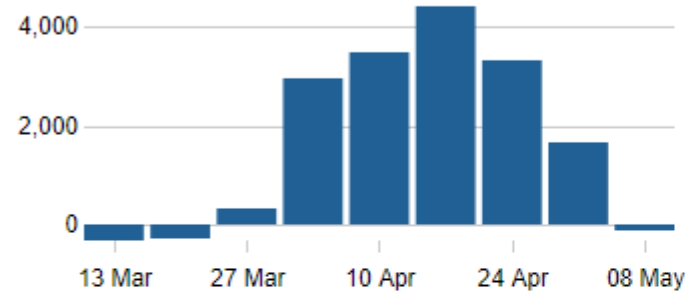

## Home

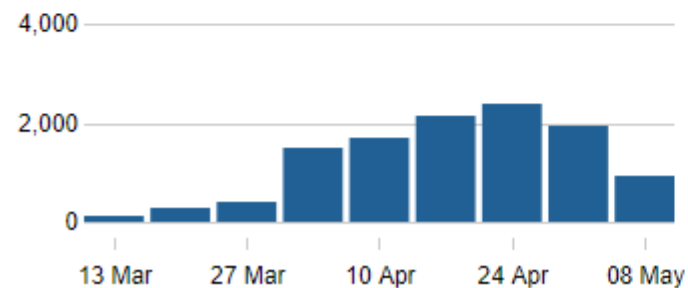

## Care home

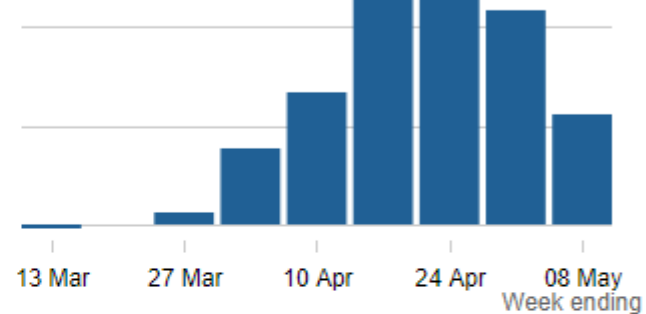

## Other communal establishment

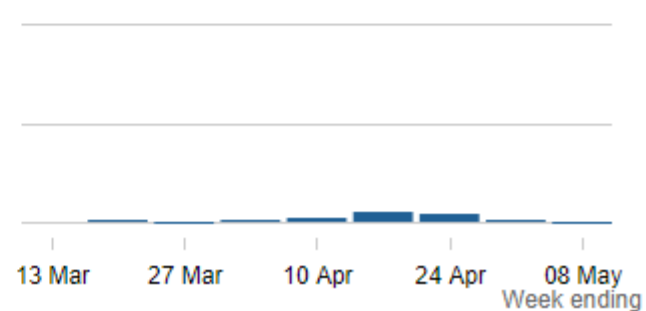



Health

## Coronavirus: Care home deaths up as hospital cases fall

By Nick Trigg  
Health correspondent

🕒 28 April 2020



Coronavirus pandemic



A third of all coronavirus deaths in England and Wales are now happening in care homes, figures show.

# PPE

- Care home guidelines have mirrored NHS guidance throughout.
- But beware images shown on social media.
- Issues with supply chain
  - NHS quickly became monopoly purchaser.
  - All care homes were not able to access online capacity tracker to order PPE at beginning of outbreak.
  - Needs to be available within hours, not within days.



# Coronavirus: vulnerable people may die alone due to impact on UK home care

**Financial pressures including cost of PPE could lead to closure of many firms, say carer groups**

- [Coronavirus - latest updates](#)
- [See all our coronavirus coverage](#)

The logo for The Guardian, featuring the words "The Guardian" in a white serif font on a dark blue background.

“Masks now cost £11.95 each - and you have to buy 1,000. I am never going to need 1,000, and I hope I won’t need them at all,” she said. “We usually buy two five-litre tubs of hand sanitiser for £30. One tub now costs £100. Gloves usually cost £1.90 for 100. Now they are £20.

Once upon a time (2013)....

## **BGS Commissioning Guidance**

High Quality Health Care for Older Care Home Residents

▶ When and where feasible, extension of the scope of enhanced clinical interventions for example sub-cut fluids and parenteral antibiotics for carefully selected patients and according to locally agreed protocols.

Status of the sector



# A ROUND OF APPLAUSE AROUND THE COUNTRY

**JOIN THE NATION IN SAYING THANKS EVERY THURSDAY AT 8PM**

# What next....

- Recycling of palliative care medicines
- The national care home “ask”
- Working out when and how to transition into Enhanced Health and Care Homes
- A fairer settlement for the sector